



SLS LUX™

BRICKELL



*scintillating*  
**LIFESTYLE**  
*scenarios*

High fashion, fine dining, and chic entertainment all come together in Brickell, Miami's most exciting and sophisticated downtown neighborhood. Elite corporate headquarters and top international financial institutions attract the most powerful and savvy business people, and the 5 million square foot Brickell CityCentre caters to clientele with refined taste.



## INTRODUCING SLS LUX: DESIGNED TO INDULGE THE SENSES

Just steps away from upcoming Brickell CityCentre, Miami's newest and most extravagant shopping and lifestyle destination, SLS LUX offers residents ultimate access in an oasis of exclusive privileges. Sophisticated designer interiors, original works of art by contemporary masters, private rooftop pool terraces, celebrity chef restaurants, and limousine service to a chic private beach club are among the many features, amenities, and services designed to indulge the most discriminating clientele.

### BUILDING FEATURES

- Located in the heart of Brickell between upcoming Brickell CityCentre's high-end retail and restaurants and the Mary Brickell Village shopping center.
- 57-story tower designed by internationally renowned architecture firm Arquitectonica, featuring the first LED façade by prominent lighting artist Ana Martinez.
- Interiors designed by Yabu Pushelberg.
- Museum-quality art in all common areas, including works by renowned artists such as Fernando Botero and Matias Duville, among others, and exterior art mural installation by Fabian Burgos.
- Ground floor restaurant by celebrated chef Katsuya Uechi and cocktail lounge by SBar.
- 450 luxury condominiums featuring private elevators.
- A limited collection of 12 Penthouse Residences on the top three floors with 12 foot ceilings, custom gourmet kitchens and panoramic skyline, Biscayne Bay, and Atlantic Ocean views.
- Two assigned self-parking spaces available for most units in secured parking garage, or optional complimentary 24-hour valet parking services.
- Rental program by sbe for designer suites.

THE ST. REGIS, BAL HARBOUR



INTERIOR DESIGN

# YABU PUSHELBERG

Canadian interior design duo George Yabu and Glenn Pushelberg were named two of the "101 People You Must Meet in 2011" by Town & Country, "Hot Interior Design Firm" by Condé Nast Traveler, and were listed on Elle Décor's "A-List." Their client roster is filled with visionaries and innovators of hotel groups and luxury retail brands as well as celebrity chefs, including Ian Schrager, Four Seasons, St. Regis, Barneys, Tiffany's, Jean-Georges Vongerichten, and Daniel Boulud. Described by Robert Champagne, AIA as "the most creative designers out there today - the ones everyone is looking to for inspiration for luxurious residential and commercial interiors", they are also James Beard Award winners for excellence in restaurant design and have been inducted into Interior Design's "Hall of Fame".

TRUMP HOLLYWOOD, HOLLYWOOD



“TO BE SURROUNDED  
BY WORLD CLASS ART  
IS AMONG THE GREATEST  
LUXURIES IN LIFE.”

- JORGE PÉREZ

FOUNDER, CHAIRMAN, AND CEO OF THE RELATED GROUP



# ARTIST COLLABORATIONS



## FABIAN BURGOS

Born in Buenos Aires, Argentina, where he currently lives and works, Fabian Burgos is a contemporary painter recognized for his use of intense color to create vibrant geometric compositions that come alive on the canvas. His work has been exhibited in dozens of solo and group exhibitions throughout Argentina.



## ANA ISABEL MARTINEZ

Venezuelan artist Ana Isabel Martinez creates interactive spaces where viewers are faced with a world of technical effects and a spectacle of forms and dynamic information. Her work has been exhibited in premier global cities, including Miami, Buenos Aires, Caracas, and Lima.



## FERNANDO BOTERO

Colombian-born Fernando Botero is among the most renowned artists of his generation. Best known for his sculptures of sensuously robust human figures, his work has been exhibited worldwide and is in the collections of dozens of major museums, including The Guggenheim and the Museum of Modern Art in New York City.



# *seek* LUX STYLE

## EXCLUSIVE SLS CONCIERGE SERVICES ON DEMAND

- Butler Services and “While Your Away” Services.
- Custom SLS LUX app to provide convenient access to concierge services from your tablet or smartphone.
- Property-wide Wi-Fi.
- Around-the-clock multilingual staff.
- 24-hour valet parking.
- 24-hour security service.
- In-room dining services in all residences and suites.
- World-class concierge services.
- Full service business center with wireless high-speed internet access and audio-visual equipment at SLS Brickell.
- Private catering for meetings, luncheons, and dinner parties at SLS Brickell.
- Shipping and packaging services.
- Currency conversion and exchange services.
- Full-time maintenance staff.
- Housekeeping on demand.
- Pre-arrival provisioning / grocery shopping and delivery.
- Dry cleaning and laundry services.
- Nanny/babysitting services.
- Plant maintenance.
- Overnight shoeshine.
- Pet services.
- Preferred theatre and event tickets.
- Courier services.
- Personal IT support assistance.
- Translation services.

## MEETINGS & EVENTS AT SLS BRICKELL

With VIP access to SLS Brickell’s event facilities and services, residents of SLS LUX can easily host any kind of event from an exclusive private party to a lavish press launch. Choose from a full menu of services and spaces.

- Customized menus.
- Experienced event management and catering specialists.
- Preferred room rate and room block for guests.
- 24-hour full-scale AV expertise and capabilities.
- Property-wide WiFi access, telephone, and web conferencing.
- Post-conference shipping.
- Concierge services.
- Multilingual staff.

## 9TH FLOOR INDOOR & OUTDOOR FEATURES:

- Expansive rooftop terrace overlooking the Brickell Skyline features a 75-foot lap pool and a separate 112-foot beach entry pool.
- Poolside cabanas and shaded lounge areas
- Juice Bar.
- Poolside bar with TV, live entertainment, and al fresco dining.
- Towel service.
- BBQ area with summer kitchen.
- Multi-use sports center with combined court for tennis, paddleball, and volleyball, a soccer academy court, basketball court, and bocce court.
- Rock climbing wall.
- Circuit training with fitness stations located throughout amenity deck.
- Outdoor area for Yoga classes.
- Outdoor Theatre.
- Total health and wellness opportunities at the SLS LUX state-of-the-art health and wellness center include cardio and weight training equipment, as well as cardio machines with personal plasma television/music options. Free weights, stretching mats, Pilates balls, yoga mats, and headphones are all available for complimentary use.
- In addition, residents can opt for an exclusive membership at Equinox Brickell and SoulCycle, located across the street in the upcoming Brickell Heights residences
- Ciel Spa at SLS Lux features beauty treatment and massage beds, specialized massage therapists on demand, experience showers, and herbal steam rooms, among other luxurious indulgences.
- Children's indoor and outdoor play areas with monitoring services and a supervised activity center led by professional staff.
- Club Room Lounge enables residents to gather with family and friends while enjoying flat-screen TVs with major sports programming with a built-in speaker system, and a fully equipped gourmet kitchen.
- Full access to the Executive Business Center at SLS Brickell, which is equipped with high speed wireless connectivity, a conference room with audio-visual equipment for private meetings, access to wireless printers and fax machines, meeting rooms, event space, and catering services.
- VIP Access to South Beach's hottest beach club, Hyde Beach at the SLS Hotel South Beach with lounges, beach and pool towel services, cabanas, and seaside snack and beverage services.

## 44<sup>TH</sup>/45<sup>TH</sup> FLOOR SKY LOUNGE

- Outdoor lounge space with two beautifully designed fire pits overlooking breathtaking views of Biscayne Bay and the Miami skyline for exclusive use of condominium residents.
- Two-story indoor lounge and recreation area with private wine cellar, billiards and poker table.

## 57<sup>TH</sup> FLOOR ROOF TOP PRIVATE SUN DECKS AND SPA

- Rooftop pool and sundeck overlooking the city skyline and breathtaking views of Biscayne Bay for building residents.



OUTDOOR YOGA



ROOFTOP BBQ



OUTDOOR THEATRE



SLS SOUTH BEACH BEACHCLUB



EXECUTIVE BUSINESS CENTER



HEALTH & WELLNESS CENTER



SBAR LOUNGE



TENNIS COURTS



CIEL SPA



ROCK CLIMBING WALL



LAP POOL



CHILDREN'S PLAYGROUND



## RESIDENCES FEATURES:

- Stunning views of Biscayne Bay and the Miami skyline.
- Residences delivered fully finished with several choices of imported porcelain tile flooring pre-selected by award-winning interior design firm Yabu Pushelberg.
- Elegant semi-private elevator with biometrics technology.
- Private vestibules in all residences.
- Spacious, fully finished walk-in closets in all master bedrooms.
- Residences available with either 9 or 10 foot smooth-finish ceilings in living spaces.
- Rain Showers and spa tubs in all master bathrooms.
- Spacious terraces with glass and aluminum railings directly accessible from living areas and bedrooms of every residence through floor-to-ceiling sliding glass doors and wrap-around terraces in all corner units.
- Select residences include barbecue grill area on terrace.
- Exclusive collection of 12 Penthouse Residences with 12-foot ceilings; some with private rooftop pools and outdoor spas.
- Pre-wired for high-speed communications multiple telephone lines and cable.
- The latest in "Smart Building" technology features custom SLS LUX app, linking residents to SLS Brickell professional concierge services and building amenities Home Automation system.
- Two self-parking spaces available for most residences.

## SLEEK KITCHENS

- Contemporary Italian kitchen cabinets by Italkraft.
- Several choices of cabinet finishes and stone counter tops pre-selected by Yabu Pushelberg. (optional full backsplashes).
- Top-of-the-line stainless steel appliance package includes integrated paneled 36" Subzero refrigerator/freezer, Wolf drawer microwave, Wolf silent dishwasher, Wolf built-in convection oven and ceramic glass stovetop.
- Stainless steel, under-mount oversized zero radius square edge sink with single lever European-style pullout faucet sprayer.

## EXQUISITE BATHS

- Premium European cabinetry with designer details, imported stone vanity tops and full size mirrors designed by Yabu Pushelberg.
- Double designer vessel bowl lavatories in master baths in select residences.
- Elongated water closet.
- Spacious spa tubs and frameless glass-enclosed showers in master baths in select residences.
- Imported porcelain flooring, base and walls in wet areas.
- Designer faucets.
- Powder Room in select residences.



*stellar*  
**LEADERSHIP**  
*synergies*



JORGE PÉREZ  
 FOUNDER, CHAIRMAN, AND CEO

CARLOS ROSSO  
 PRESIDENT, CONDOMINIUM  
 DEVELOPMENT DIVISION



W. ALLEN MORRIS  
 CHAIRMAN & CEO



SAM NAZARIAN  
 FOUNDER, CHAIRMAN AND CEO



GLENN PUSHELBERG & GEORGE YABU  
 FOUNDING PARTNERS



BERNARDO FOT-BRESCIA  
 FOUNDING PRINCIPAL

**THE RELATED GROUP**

Founded in 1979 by Jorge M. Pérez, The Related Group is the nation's leading developer of multi-family residences. Under his direction, as well as the leadership of Carlos Rosso, President of Condominium Development Division, The Related Group and its affiliates have redefined the South Florida landscape. Since its inception, The Related Group has developed and/or managed more than 80,000 apartments and condominium residences. Its many distinctive properties in South Florida include Portofino Tower, the Yacht Club at Portofino, Murano at Portofino, Murano Grande, and Icon South Beach.

The Related Group's developments are often distinguished by groundbreaking partnerships with world-renowned architects, designers, and artists, resulting in residential properties that are recognized as urban landmarks. Awards the company has earned include the prestigious Honor Award from the National Building Museum. In addition, Icon Brickell has won 18 BEST awards from the Builders Association of South Florida. The company and its leadership are committed to developing properties that energize cities, celebrate innovative architecture and urban planning, and create vibrant new ways to live in the most dynamic neighborhoods.

**ALLENMORRIS**

Led by W. Allen Morris, Chairman & CEO, The Allen Morris Company is a 56 year old firm founded in Miami in 1958. It develops, brokers, leases, and manages commercial and multi-family properties across the Southeastern US, with 79 developments to its credit. Allen Morris Residential creates unique, inspiring lifestyle experiences for residential condominiums and apartment homes. Mr. Morris was recognized with the 2011 Real Estate Trend Setter Award from the Greater Miami Chamber of Commerce and was named the 2009 South Florida Business Leader of the Year in real estate.

**SBE**

sbe Founder, Chairman and CEO Sam Nazarian has been a transformative force in revolutionizing contemporary hospitality. In only a decade, he has defined "the scene" in Los Angeles and beyond, driving sbe to become the creative wellspring for some of the most sought-after luxury lifestyle brands in North America. The youngest executive to be named one of the "Top 100 Most Powerful People in Southern California" by West, the Los Angeles Times' magazine, Nazarian was also named among "The Influentials" in Los Angeles Magazine and was recently honored with the Mondavi Wine & Food award.

**YABU PUSHELNERG**

Serving global clientele from locations in New York City and Toronto, Canada, the design studio of Yabu Pushelberg is divided into six teams comprised of experts in the design and project management of luxury interiors. The firm has been honored with the Platinum Circle Award for exceptional achievement in the hospitality industry and the James Beard Foundation award for excellence in restaurant design. Partners George Yabu and Glenn Pushelberg were named Designer of the Year by Contract magazine, and they have been inducted into Interior Design magazine's "Hall of Fame".

**ARQUITECTONICA**

Arquitectonica is a Miami-based architecture, interior design and planning firm led by Bernardo Fort-Brescia and Laurinda Spear. Working from offices across North America, Latin America, Europe, Asia and the Middle East, the firm designs mixed-use developments, resorts, hotels, luxury condominiums, schools, universities and museums. Mr. Fort-Brescia is the recipient of multiple awards, including the 1998 AIA Silver Medal for Design Excellence. His work has been featured in thousands of publications internationally and has been the subject of numerous museum exhibitions worldwide.



*singularly*  
**LUXURIOUS**  
*scene*

Introducing SLS LUX, the latest evolution of the SLS Hotels and Residences brand. SLS LUX creates an environment for hotel guests and residents alike that indulges the senses and creates a comfortable luxury unlike any other. Dramatic interiors, commissioned art installations and original works of art by contemporary masters create an atmosphere that is as unique as it is exclusive. An extensive menu of personal services ensures that every need is anticipated and catered to with perfection.



SOUTH MIAMI AVENUE

8TH STREET

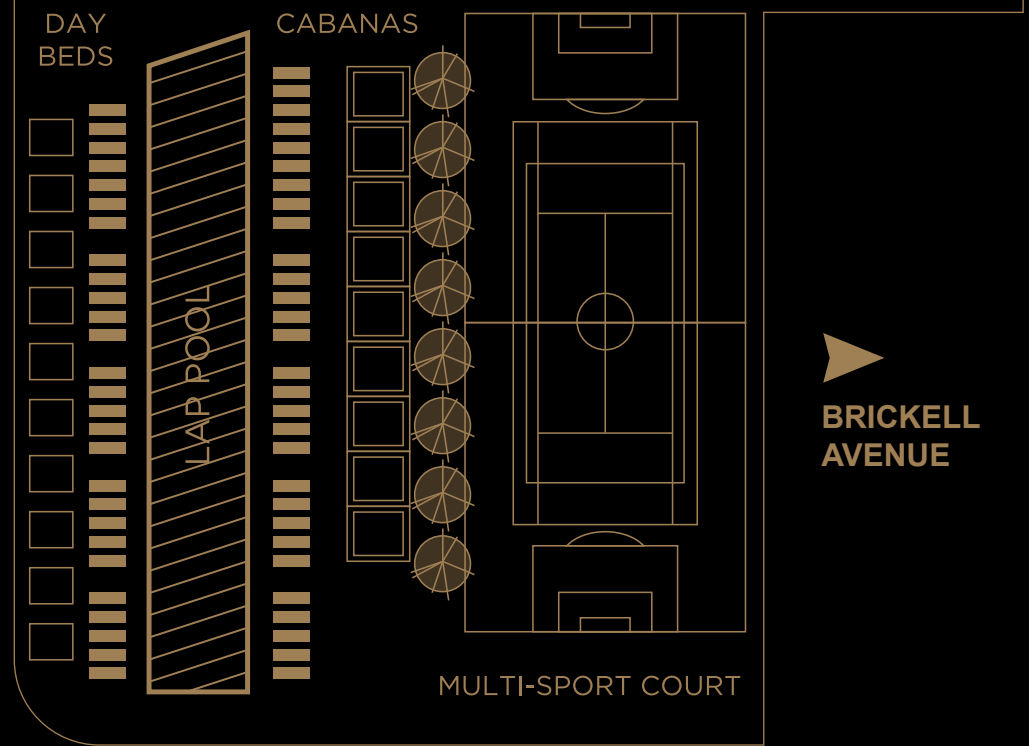
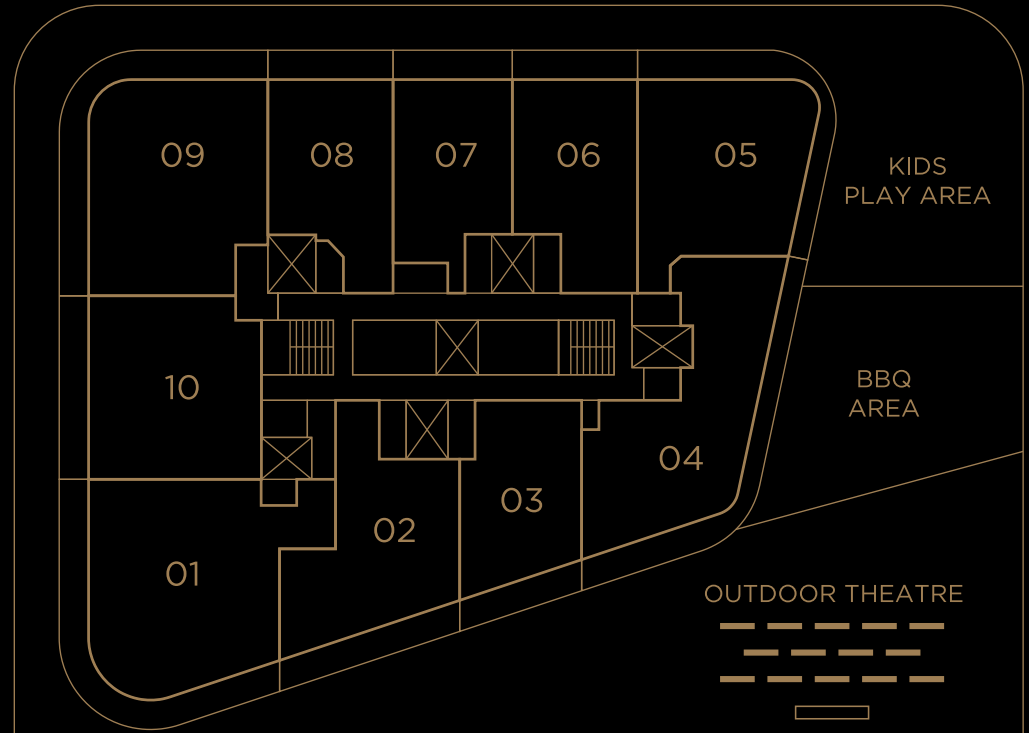

BRICKELL AVENUE

### SLS RESIDENCE 01 3 BEDROOMS & DEN / 4 BATHS

A/C INTERIOR AREA	1,779 SQ. FT.	165.27 SQ. M.
TERRACE AREA	505 SQ. FT.	46.91 SQ. M.
TOTAL RESIDENCE	2,284 SQ. FT.	212.18 SQ. M.

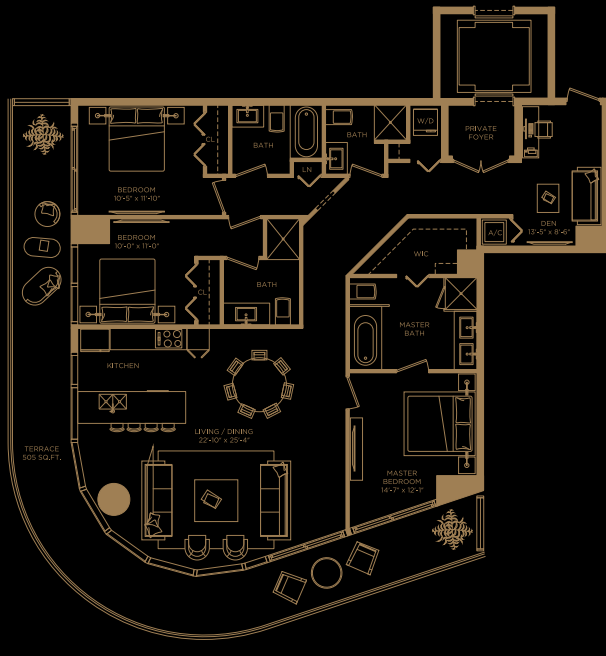
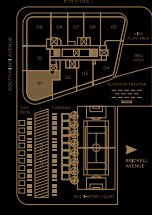

### SLS RESIDENCE 02 2 BEDROOMS & DEN / 2 1/2 BATHS

A/C INTERIOR AREA	1,250 SQ. FT.	116.12 SQ. M.
TERRACE AREA	234 SQ. FT.	21.73 SQ. M.
TOTAL RESIDENCE	1,484 SQ. FT.	137.85 SQ. M.

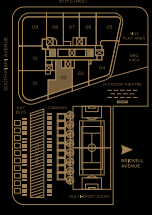

### SLS RESIDENCE 03 1 BEDROOM & DEN / 1 1/2 BATHS

A/C INTERIOR AREA	945 SQ. FT.	87.79 SQ. M.
TERRACE AREA	159 SQ. FT.	14.77 SQ. M.
TOTAL RESIDENCE	1,104 SQ. FT.	102.56 SQ. M.

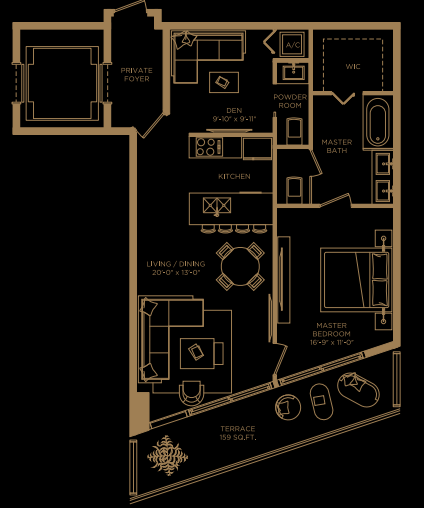
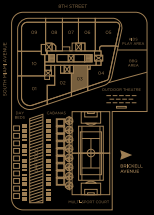

### SLS RESIDENCE 04 3 BEDROOMS / 3 BATHS

A/C INTERIOR AREA	1,502 SQ. FT.	139.54 SQ. M.
TERRACE AREA	414 SQ. FT.	38.46 SQ. M.
TOTAL RESIDENCE	1,916 SQ. FT.	178 SQ. M.

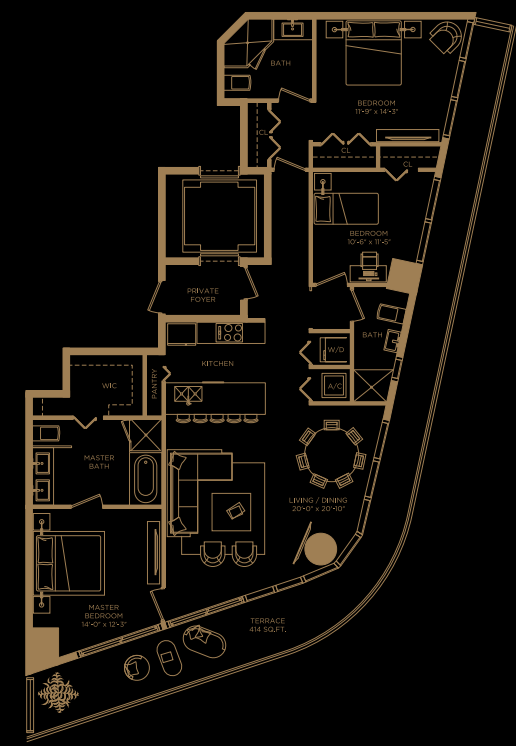
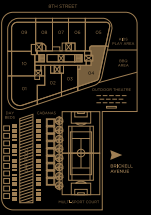

### SLS RESIDENCE 05 2 BEDROOMS / 2 BATHS

A/C INTERIOR AREA	1,353 SQ. FT.	125.69 SQ. M.
TERRACE AREA	350 SQ. FT.	32.51 SQ. M.
TOTAL RESIDENCE	1,703 SQ. FT.	158.20 SQ. M.

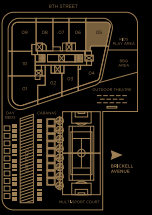

### SLS RESIDENCE 06 1 BEDROOM & DEN / 2 BATHS

A/C INTERIOR AREA	1,075 SQ. FT.	99.87 SQ. M.
TERRACE AREA	153 SQ. FT.	14.21 SQ. M.
TOTAL RESIDENCE	1,228 SQ. FT.	114.08 SQ. M.

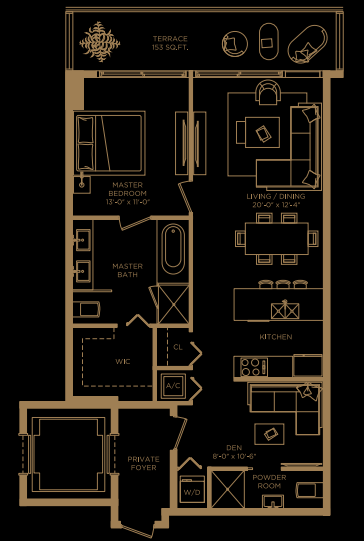
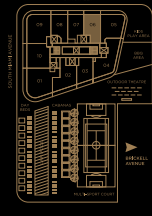

### SLS RESIDENCE 07 1 BEDROOM & DEN / 1 1/2 BATH

A/C INTERIOR AREA	955 SQ. FT.	88.72 SQ. M.
TERRACE AREA	153 SQ. FT.	14.21 SQ. M.
TOTAL RESIDENCE	1,108 SQ. FT.	102.93 SQ. M.

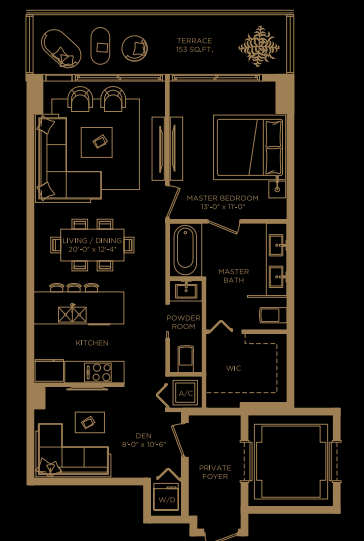
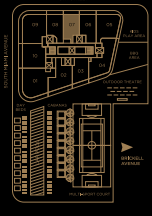

### SLS RESIDENCE 08 1 BEDROOM & DEN / 2 BATHS

A/C INTERIOR AREA	1,010 SQ. FT.	93.83 SQ. M.
TERRACE AREA	153 SQ. FT.	14.21 SQ. M.
TOTAL RESIDENCE	1,163 SQ. FT.	108.04 SQ. M.

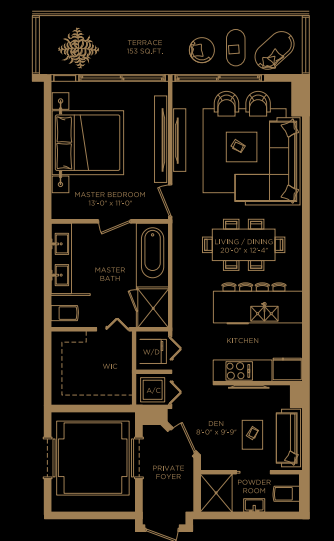
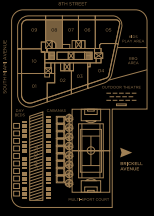

### SLS RESIDENCE 09 3 BEDROOMS / 3 BATHS

A/C INTERIOR AREA	1,660 SQ. FT.	154.21 SQ. M.
TERRACE AREA	490 SQ. FT.	45.52 SQ. M.
TOTAL RESIDENCE	2,150 SQ. FT.	199.73 SQ. M.

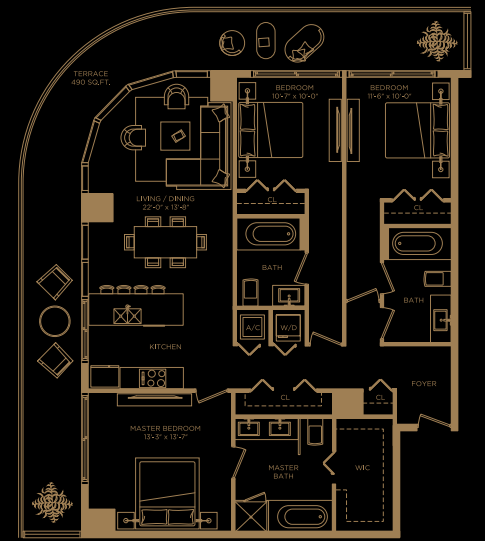
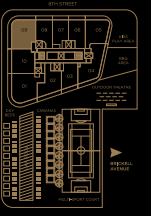

### SLS RESIDENCE 10 2 BEDROOMS & DEN / 2 BATHS

A/C INTERIOR AREA	1,394 SQ. FT.	129.50 SQ. M.
TERRACE AREA	226 SQ. FT.	20.99 SQ. M.
TOTAL RESIDENCE	1,620 SQ. FT.	150.49 SQ. M.

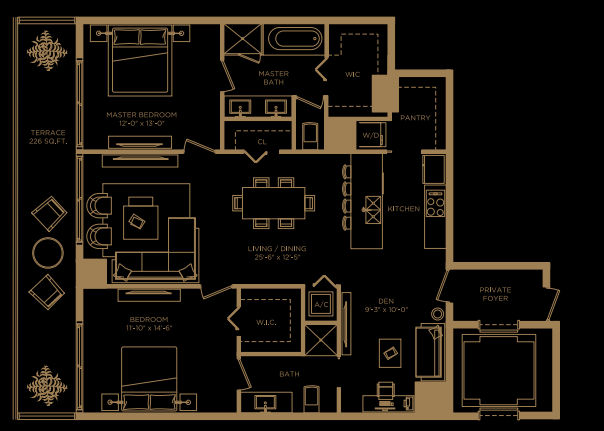
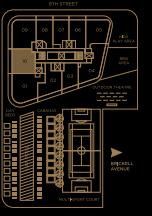

 Each purchaser is advised that there are various methods for calculating the square footage of a Unit, and that, depending on the method of calculation, the quoted square footage of a Unit in advertising materials may vary from the square footage quoted in the Prospectus and Declaration. The dimensions of the Unit shown in these floor plans have been calculated from the exterior boundaries of the exterior walls to the centerline of interior demising walls, including common elements such as structural walls and other interior structural components of the building, and in fact vary from the dimensions that would be determined by using the description and definition of the "Unit" set forth in the Prospectus and Declaration. The area of the Unit as defined in the Prospectus and Declaration is less than the square footage reflected here. Measurements of rooms set forth on this floor plan are generally taken at the greatest points (as if the room were a perfect rectangle), without regard for any cutouts, meaning the usable area of the actual room will typically be smaller than calculated by multiplying the length times width. All dimensions are approximate; may vary with actual construction; and are subject to development plans which may change. The furnishings and décor illustrated or depicted are not included with the purchase of the Unit. See Prospectus for information on what is offered with the Unit and the Unit square footage and dimensions.



Photography by MATTHEW ROLSTON  
GOLDEN HOURS, BEVERLY HILLS, 2012

SEE LEGAL DISCLAIMERS ON BACK COVER

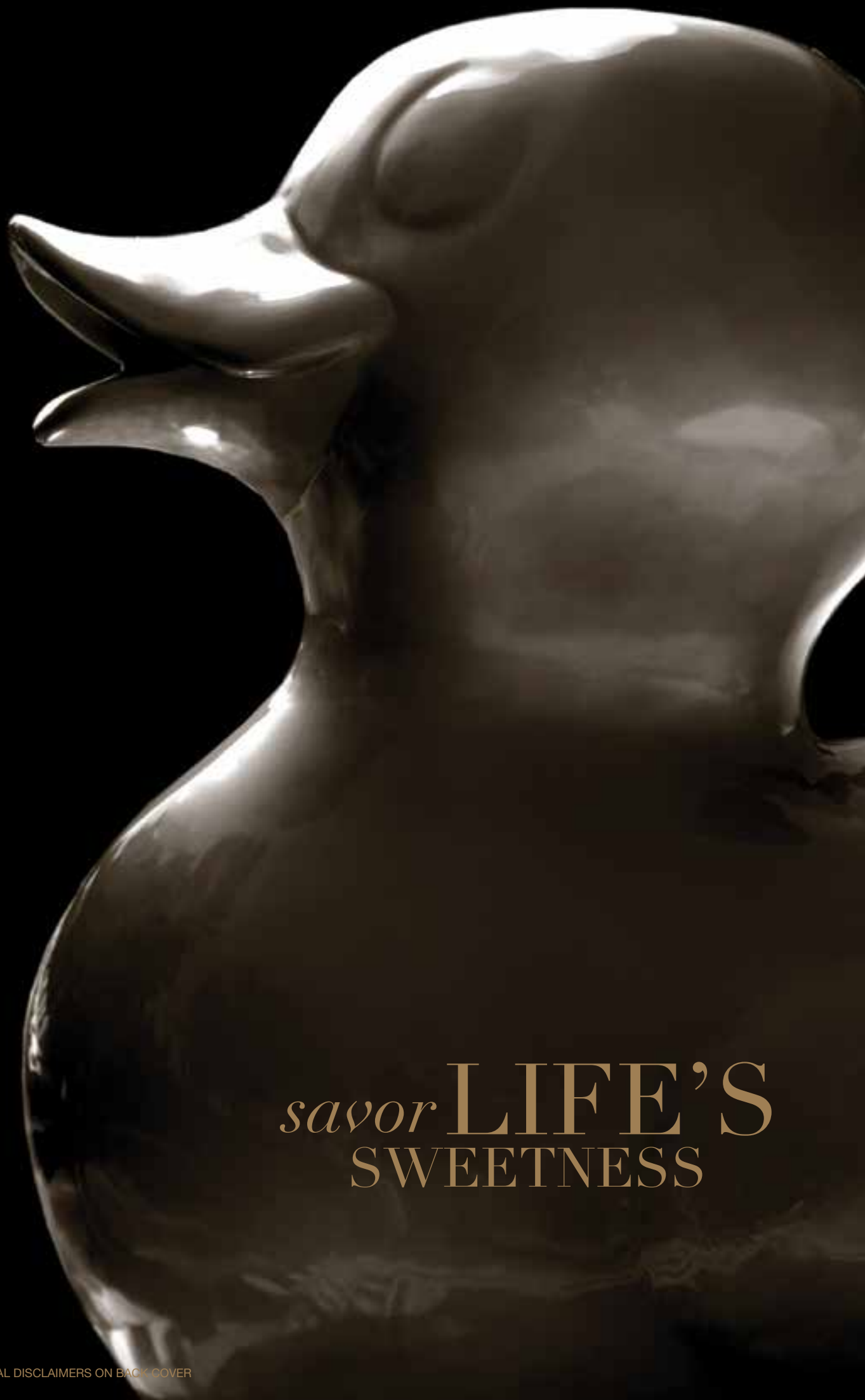

# *savor* LIFE'S SWEETNESS

SEE LEGAL DISCLAIMERS ON BACK COVER

ON-SITE SALES GALLERY  
801 SOUTH MIAMI AVENUE, MIAMI, FLORIDA 33129

T: 305 890-2026  
WWW.SLSLUX-BRICKELL.COM

 RELATED  sbe  ALLENMORRIS

 OBTAIN THE PROPERTY REPORT REQUIRED BY THE FEDERAL LAW AND READ IT BEFORE SIGNING ANYTHING. NO FEDERAL AGENCY HAS JUDGED THE MERITS OR VALUE, IF ANY, OF THIS PROPERTY.

ORAL REPRESENTATIONS CANNOT BE RELIED UPON AS CORRECTLY STATING THE REPRESENTATIONS OF THE DEVELOPER. FOR CORRECT REPRESENTATIONS, MAKE REFERENCE TO THIS BROCHURE AND TO THE DOCUMENTS REQUIRED BY SECTION 718.503, FLORIDA STATUTES, TO BE FURNISHED BY A DEVELOPER TO A BUYER OR LESSEE.

This is not intended to be an offer to sell, or solicitation of an offer to buy, condominium units to residents of CT, ID, NY, NJ and OR, unless registered or exemptions are available, or in any other jurisdiction where prohibited by law, and your eligibility for purchase will depend upon your state of residency. This offering is made only by the Prospectus for the condominium and no statement (verbal or written) should be relied upon if not made in the Prospectus. Any sketches, renderings, graphic materials, plans, specifications, terms, conditions and statements contained in this brochure are proposed only, and the Developer (as is defined herein below) reserves the right to modify, revise or withdraw any or all of same in its sole discretion and without prior notice. Consult your Purchase Agreement and the Prospectus for the items included with the Unit. The Developer expressly reserves the right to make modifications, revisions, and changes it deems desirable or necessary in its sole and absolute discretion. All improvements, designs and construction are subject to first obtaining the appropriate federal, state and local permits and approvals for same. The photographs contained in this brochure may be stock photography or may have been taken off-site and are used to depict the spirit of the lifestyles to be achieved rather than any lifestyle that may exist or that may be proposed. Certain nearby attractions, shopping venues, restaurants, and activities referenced are off-site and not controlled by the Developer. Any such references are accurate as of the date of this publication; however, there is no guarantee that such attractions, shopping venues, restaurants, and activities will exist, or remain without change, by the time the condominium is complete or after. The designers, managing entities, hotel operators, restaurants operations, amenities, and services proposed and art pieces depicted or pictured within the condominium are accurate as of the date of this publication; however, the Developer reserves the right to terminate, change, or substitute with comparable quality, any or all such designers, managing entities, hotel operators, restaurant operations, amenities, services, and art pieces as the Developer deems best for the condominium in the Developer's sole and absolute discretion. This condominium is being developed by AMCO PRH 801 South Miami Avenue, LLC ("Developer"), which has a limited right to use the trademarked names and logos of The Related Group, Allen Morris Company, and SBE Hotels, LLC. No representation is made or intended with respect to any perceived investment value derived by ownership in this condominium nor the economic or tax benefit of owning any unit in this condominium. No real estate broker or sales agent is authorized to make any representations or other statements (verbal or written) regarding the project, and no agreements with, deposits paid to, or other arrangements made with, any real estate broker or sales agent is binding on the Developer. © 2014 AMCO PRH 801 South Miami Avenue, LLC. All rights reserved unless otherwise credited to another. Unauthorized reproduction, display or other dissemination of such materials is strictly prohibited and constitutes copyright infringement.